

C6 / C6M CONTROLLER

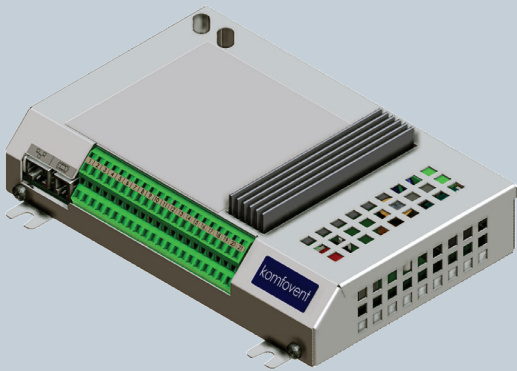

FIRMWARE
UPDATE
INSTRUCTIONS

EN

C6/C6M controller firmware can be updated when connected computer to the AHU. This can be done by connecting computer directly as well via local computer network or internet.

To update firmware on C6/C6M controller perform following steps:

1. Stop AHU by pressing **TURN OFF** button on the control panel.

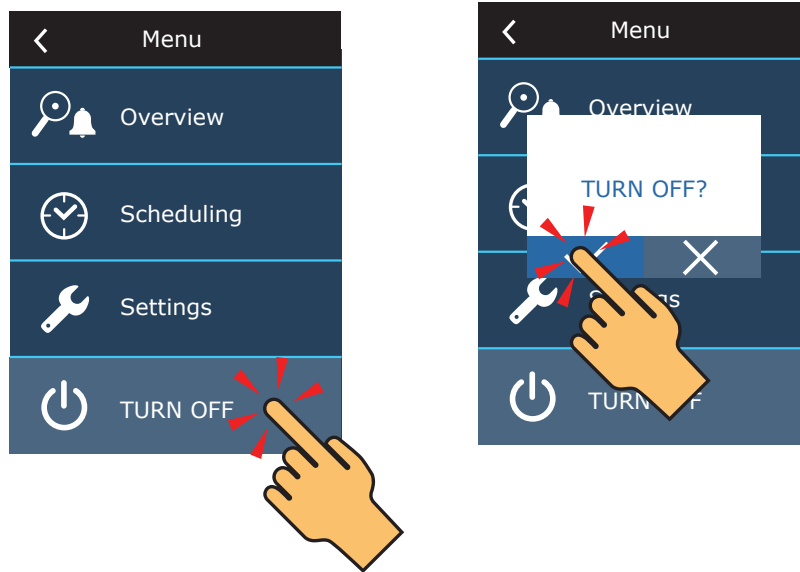

2. On the control panel find the IP address of the ventilation unit.

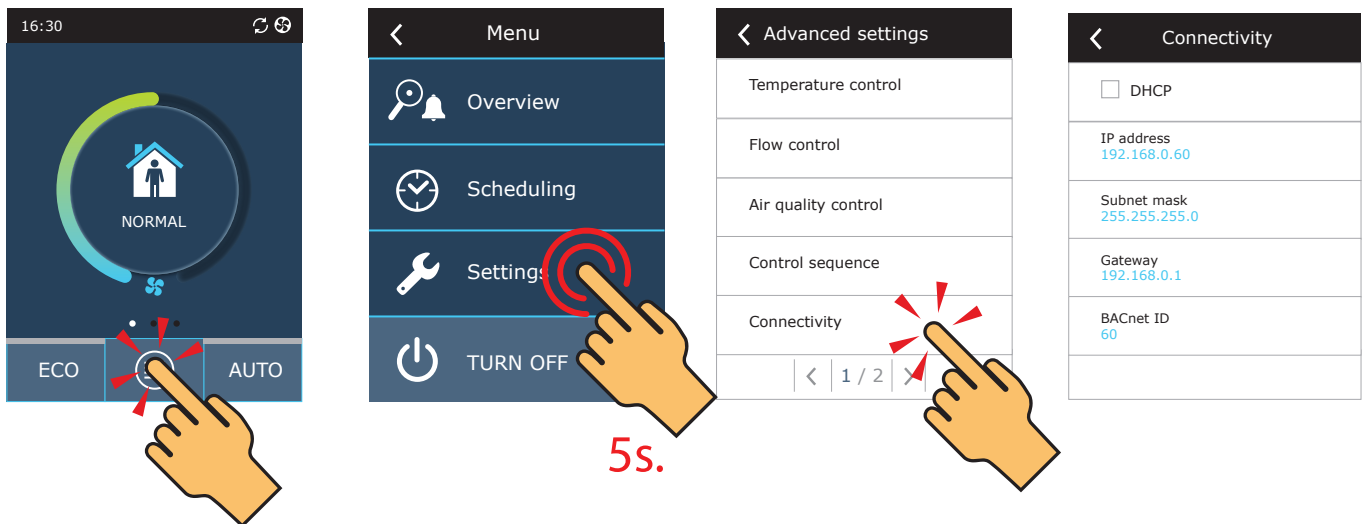

3. Connect AHU to computer or to local computer network¹.

4. On the computer start Internet browser application and enter IP address that was found in the control panel.

5. Connect to the C6/C6M user interface: enter user name **user**, password **user**² and press **Login** button.

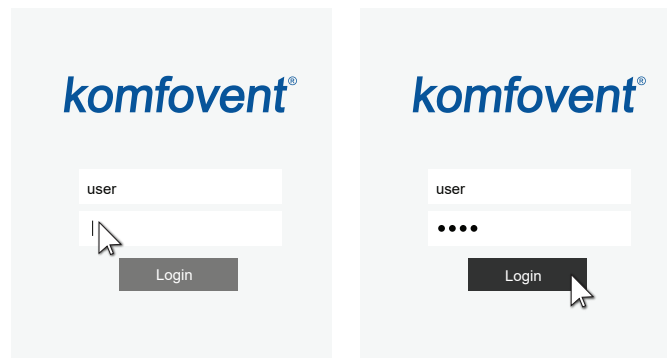

¹ More information about connecting AHU to computer or network can be found in the Domekt user manual.

² If password was changed, please use the actual one.

6. Press **SETTINGS**¹ button.

< SETTINGS

USER INTERFACE

Language

Flow units

AHU name

DATE/TIME

Day - month - year

Time

CONNECTIVITY

Status

DHCP

IP address

Subnet mask

Gateway

BACnet ID

BACnet Port

Modbus RTU

INFORMATION

Configuration

Main module firmware

Control panel firmware (1)

Control panel firmware (2)

S/N

C6 ID

C6 QR

Log

Settings file

LOGIN PASSWORD

Enter new password

Confirm new password

CONTROL MODE

Flow control mode

Supply flow correction

Extract flow correction

Temperature control mode

CONTROL SEQUENCE

Icing protection

Indoor humidity Auto

Stage 1

Stage 2

External coil type

Stage 3

Allow dehumidifying with cooling

AIR QUALITY

Impurity control

Humidity control

Sensor 1

Sensor 2

Outdoor humidity

Minimum intensivity

Maximum intensivity

Check period

FILTERS

Clean filters calibration

CLOUD

"Komfovent Control" password

¹ Settings screen may differ on different firmware versions.

7. In the **INFORMATION** section check current firmware versions of the controller and control panel (firmware version is the last number; for example 1.3.17.20 means that version number is 20).

8. If current control panel version is X.X.X.10 or latter, control panel firmware will be updated together with C6/C6M controller firmware. If control panel version is older – only C6/C6M controller can be updated.

9. Download update file from KOMFOVENT website, using following links:

9.1. [Update file for units with main module firmware version X.X.X.15 or later](#)

9.2. [Intermediate update file for units with main module firmware version X.X.X.14 or earlier](#)

10. In the internet browser application window enter IP address of the AHU and add **/g1.html**.

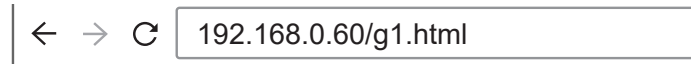

11. If prompted enter user name and password again (see step 5).

12. When screen loads click **Browse**¹ button and specify location of the update file on your computer:

12.1. If control main module firmware version is X.X.X.15 or later, chose *.mbin file

12.2. If control main module firmware version is X.X.X.14 or earlier, chose *.bin file

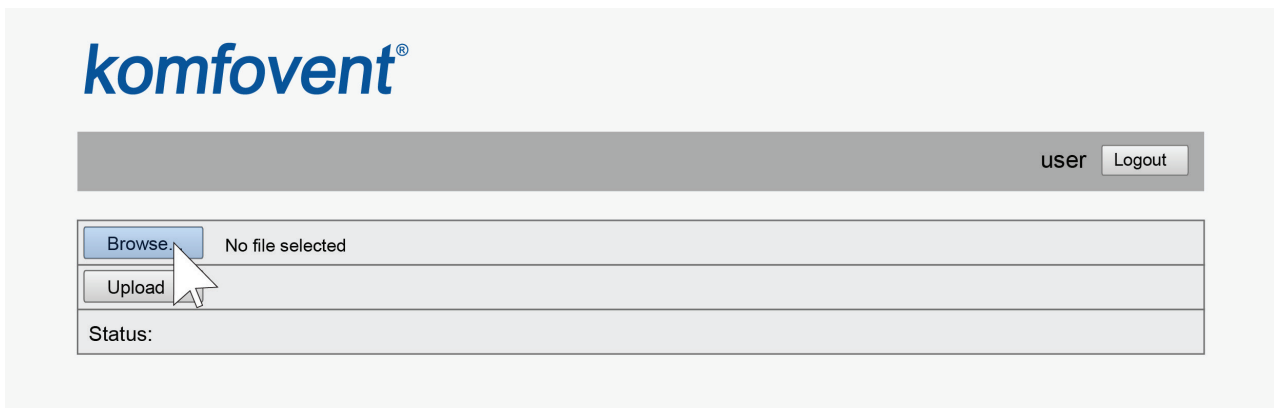

13. When update file is selected, press **Upload** button.

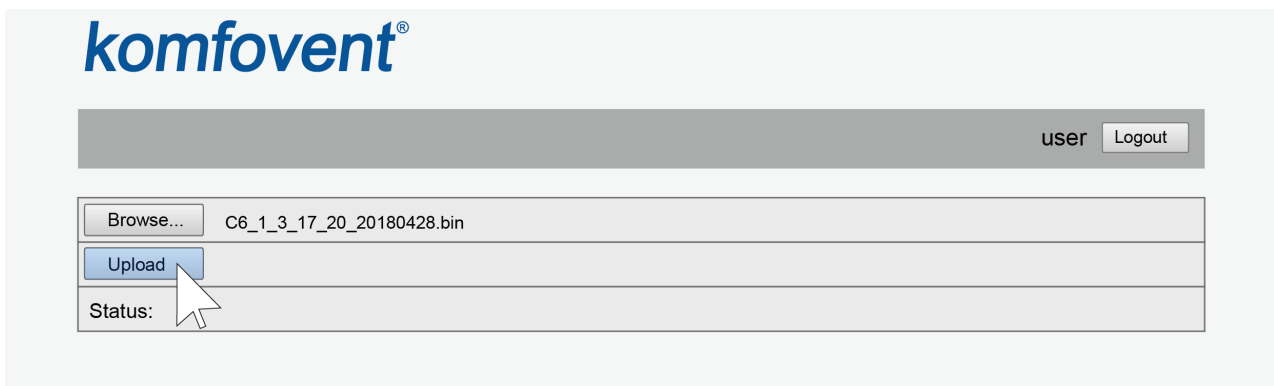

14. In the **Status** line „uploading“ will be displayed.

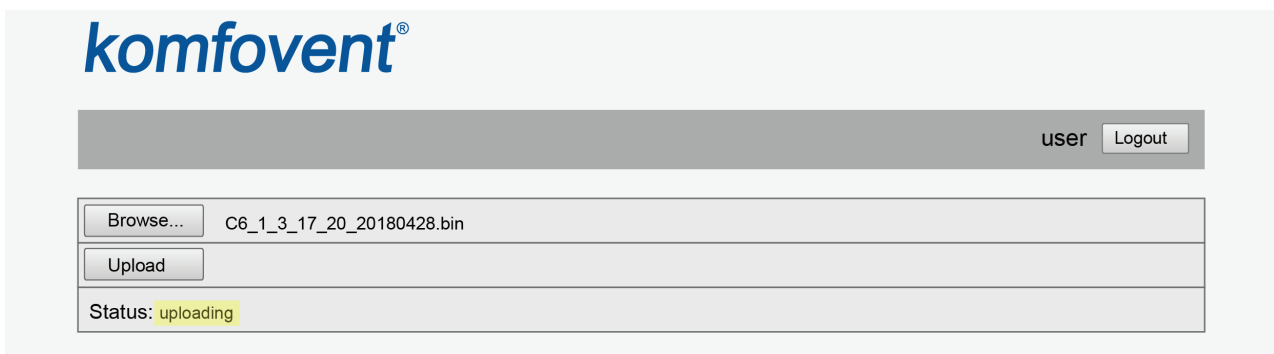

¹ Names of the buttons may be different on different internet browsers.

15. After 30–60 seconds the **Status** line will change to:

15.1. „Firmware uploaded successfully, device is restarting. Panel firmware upload success: wait until finished“, if at the same time control panel firmware was updated

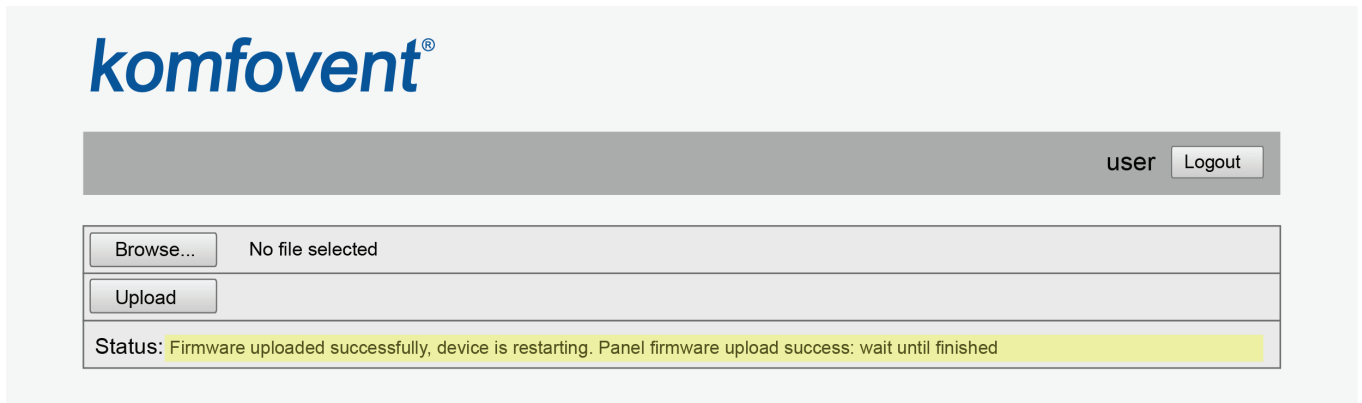

15.2. „Firmware uploaded successfully, device is restarting.“, if only C6/C6M controller was updated:

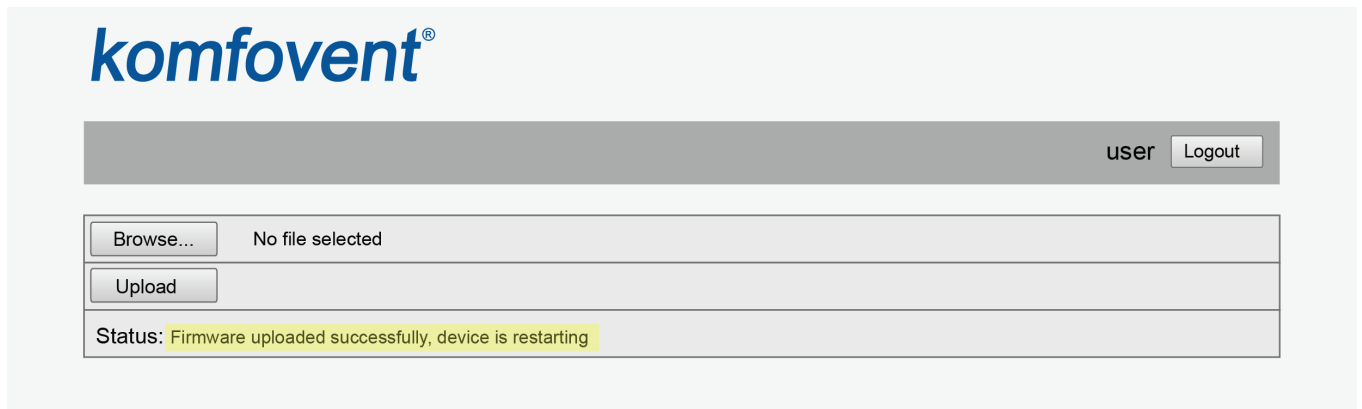

15.3. “Firmware upload error”, if update was not successful (see step 21).

16. Wait for 1–2 minutes, until controller will update the firmware and restart.

16.1. If control panel firmware was updated, on the panel screen “Updating” will be displayed together with the status bar.

16.2. Wait for 1–2 minutes, until control panel firmware will be updated and main screen will return.

17. If C6/C6M controller firmware version before the update was X.X.X.10 or earlier, after update IP address of the unit was restored to default 192.168.0.60. If needed it can be changed using control panel (see step 2).

18. If C6/C6M controller firmware version before the update was X.X.X.14 or earlier, repeat steps 10-16, but use *.mbin update file instead.

19. Check new firmware version number in the internet browser (see steps 4-7) and if OK you can use ventilation unit normally.

20. If control panel firmware version is X.X.X.9 or earlier, new functions introduced with C6/C6M controller update will be available only in the web interface and will not be shown on the control panel display, however the control panel will work normally as before the update. In case if new function access from the control panel is needed – control panel should be replaced with a new one.

21. If firmware update has failed, please perform the following steps and try to update again:

- Make sure correct update file was used (see steps 9 and 12)
- Turn OFF main power for the AHU, wait for 1 minute and turn the power ON
- Restart computer that is used for updated
- Use different internet browser
- Connect computer directly to the AHU (not through a network or internet)

If still firmware update is not successful please contact Komfovent service department.

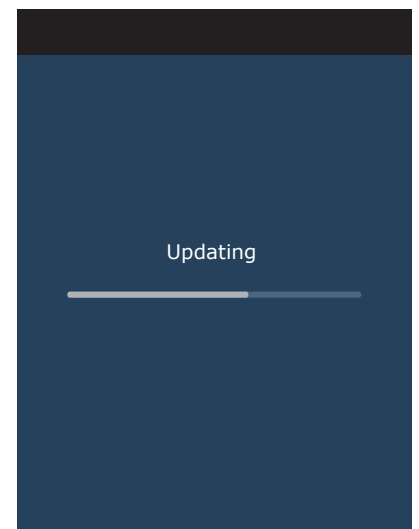

SERVICE AND SUPPORT

LITHUANIA

UAB KOMFOVENT

Phone: +370 5 200 8000
service@komfovent.com
www.komfovent.com

FINLAND

Komfovent Oy

Muuntotie 1 C1
FI-01 510 Vantaa, Finland
Phone: +358 20 730 6190
toimisto@komfovent.com
www.komfovent.com

GERMANY

Komfovent GmbH

Konrad-Zuse-Str. 2a,
42551 Velbert, Deutschland
Phone: +49 0 2051 6051180
info@komfovent.de
www.komfovent.de

LATVIA

SIA Komfovent

Bukaišu iela 1, LV-1004 Riga, Latvia
Phone: +371 24 66 4433
info.lv@komfovent.com
www.komfovent.com

Vidzemes filiāle

Alejas iela 12A, LV-4219 Valmiermuiža,
Valmieras pagasts, Burtnieku novads
Phone: +371 29 358 145
kristaps.zaicevs@komfovent.com
www.komfovent.com

SWEDEN

Komfovent AB

Ögärdesvägen 12A
433 30 Partille, Sverige
Phone: +46 31 487 752
info_se@komfovent.com
www.komfovent.se

UNITED KINGDOM

Komfovent Ltd

Unit C1 The Waterfront
Newburn Riverside
Newcastle upon Tyne NE15 8NZ, UK
Phone: +447983 299 165
steve.mulholland@komfovent.com
www.komfovent.com

PARTNERS

AT	J. PICHLER Gesellschaft m. b. H.	www.pichlerluft.at
BE	Ventilair group ACB Airconditioning	www.ventilairgroup.com www.acbairco.be
CZ	REKUVENT s.r.o.	www.rekuvent.cz
CH	WESCO AG SUDCLIMATAIR SA CLIMAIR GmbH	www.wesco.ch www.sudclimatair.ch www.climair.ch
DK	Øland A/S	www.oeland.dk
EE	BVT Partners	www.bvtpartners.ee
FR	ATIB	www.atib.fr
HR	Microclima	www.microclima.hr
HU	AIRVENT Légtechnikai Zrt. Gevent Magyarország Kft. Merkapt	www.airvent.hu www.gevent.hu www.merkapt.hu
IE	Lindab	www.lindab.ie
IR	Fantech Ventilation Ltd	www.fantech.ie
IS	Blikk & Tækniþjónustan ehf Hitataekni ehf	www.bogt.is www.hitataekni.is
IT	Icaria srl	www.icariavmc.it
NL	Ventilair group DECIPOL-Vortvent CLIMA DIRECT BV	www.ventilairgroup.com www.vortvent.nl www.climadirect.com
NO	Ventilution AS Ventistål AS Thermo Control AS	www.ventilution.no www.ventistal.no www.thermocontrol.no
PL	Ventia Sp. z o.o.	www.ventia.pl
SE	Nordisk Ventilator AB	www.nordiskventilator.se
SI	Agregat d.o.o	www.agregat.si
SK	TZB produkt, s.r.o.	www.tzbprodukt.sk
UA	TD VECON LLC	www.vecon.ua